

- 3 - ELEVATOR PIT BY OTHERS
NOT TO SCALE

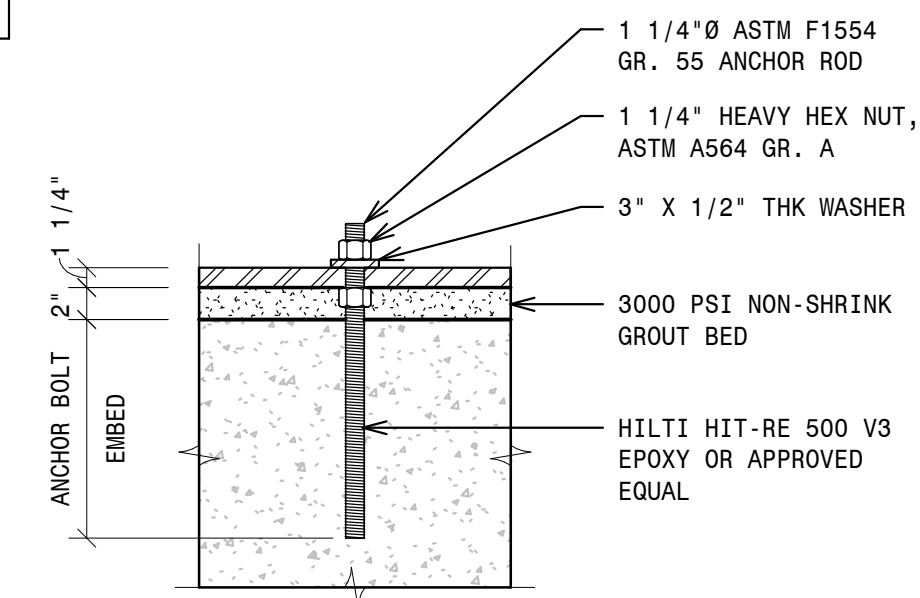

- 2 - TYPICAL ANCHOR BOLT INSTALLATION
NOT TO SCALE

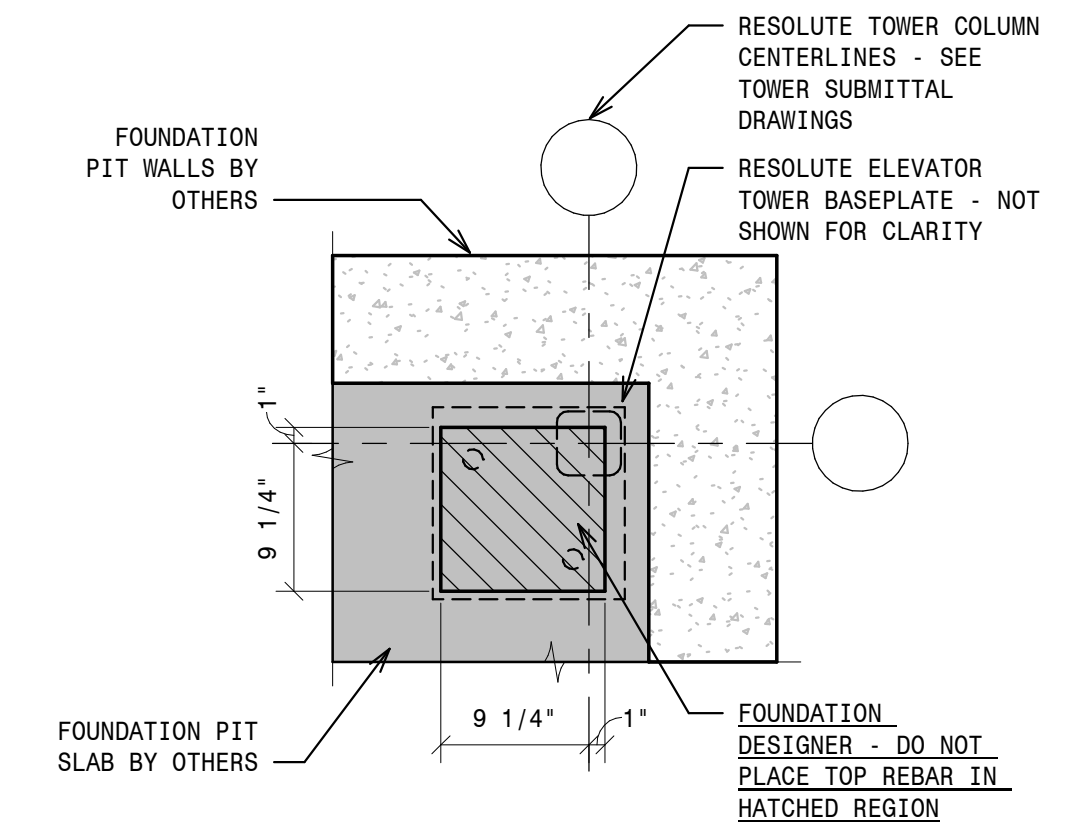

- 1 - FOUNDATION REBAR BLOCKOUT
NOT TO SCALE

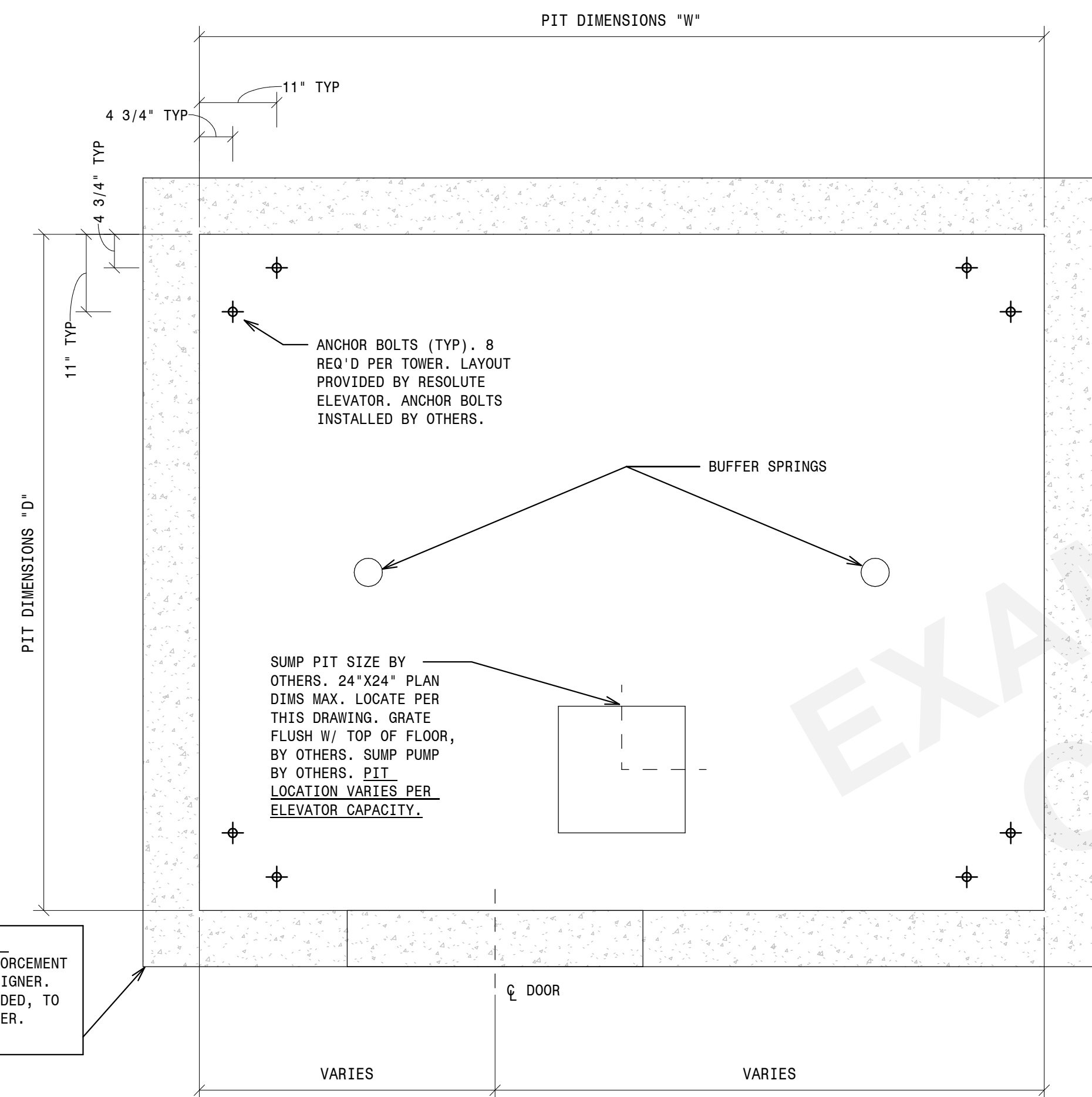

PIT CLEAR DIMENSIONS			
CAPACITY, (LBS)	OPENINGS (F=FRONT, R=REAR)	W	D
2100	F	9'-0"	6'-11"
	F&R	9'-0"	7'-9 3/4"
2500	F	10'-0"	6'-11"
	F&R	10'-0"	7'-9 3/4"
3500	F	10'-0"	8'-0"
	F&R	10'-0"	9'-0 3/4"
4500	F	9'-0"	10'-8 1/2"
	F&R	9'-0"	11'-10 1/2"

NOTES:
 - DIMENSIONS SHOWN ARE TYPICAL FOR BOTH HYDRAULIC AND TRACTION ELEVATOR MODELS.
 - DIMENSIONS SHOWN ARE CLEAR BETWEEN PIT WALLS.

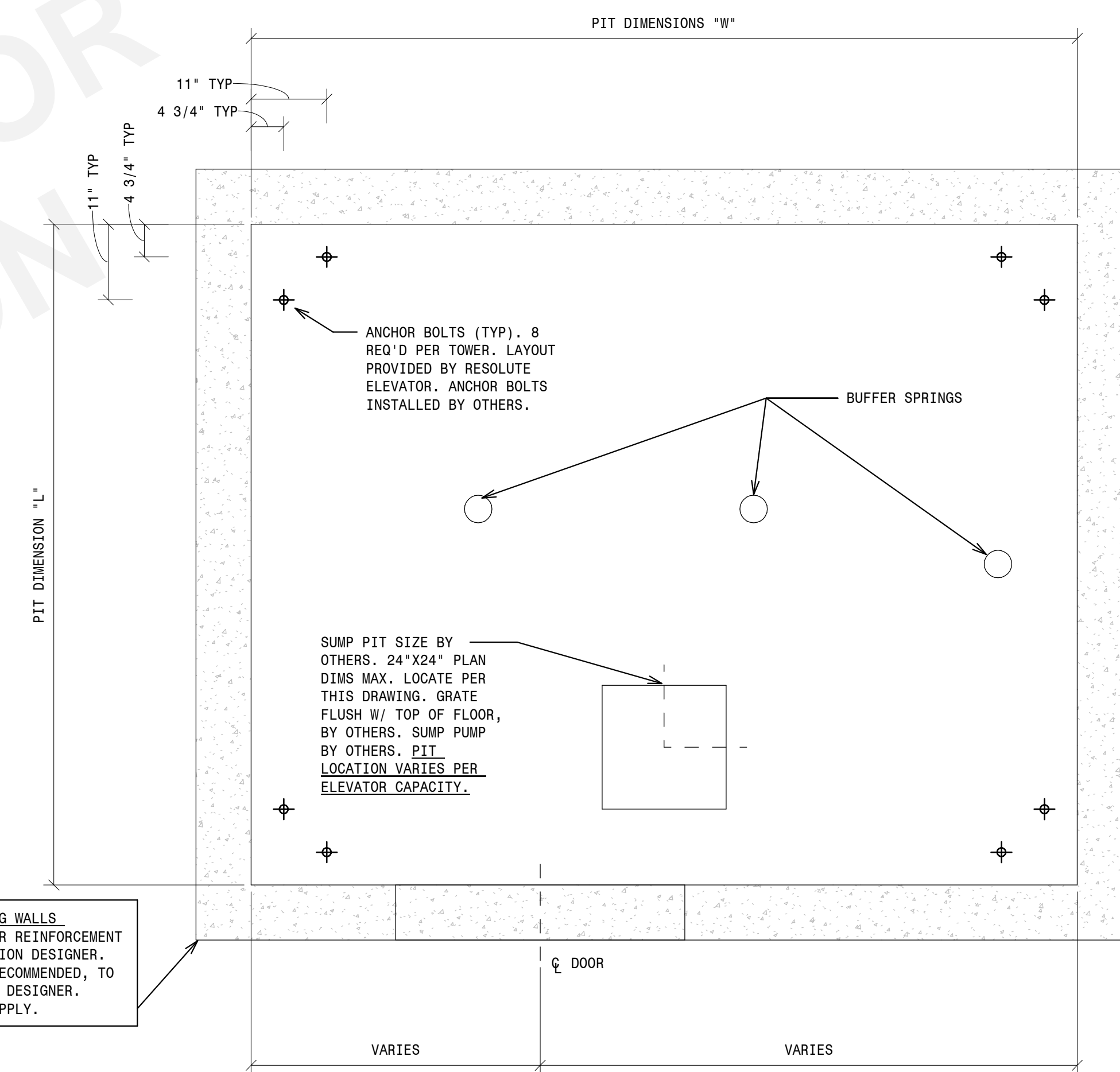

- 4 - TRACTION MODEL PIT PLAN
3/4" = 1'-0"

- 5 - HYDRAULIC MODEL PIT PLAN
3/4" = 1'-0"

REVISIONS

NOT FOR CONSTRUCTION

PROJECT NO.
 DATE: 4/15/2006
 SCALE: As indicated

DES. BY: NLH
 DWG. BY: SPFNH
 CHKD. BY: NLH

PROJECT ID #S

SEAL

RESOLUTE ELEVATOR

FOUNDATION DETAILS



2309 AIRPARK DR.,
 BURLINGTON, NC 27215
 PHONE: (919)-903-0189
 FAX: (336)-232-9789
 Info@resoluteelevator.com
 www.ResoluteElevator.com
 NC Firm No. D-0476

SHEET NO.

RS.02